

# PLAYAMAR X

## Quality description

### **STRUCTURE**

Concrete foundation base slab, using special marine concrete.

Structure with reinforced concrete complying with the CTE regulation.

Concrete perimeter foundation to erect boundary walls.

Concrete for paved/tiled garden area (as detail drawings).

Concrete decorative finishes (as detailed drawings).

### **FACADE:**

External double cavity walls using ceramic bricks, with cavity walls.

Cavity walls with thermal / acoustic insulation, As per current building regulations (CTE).

Facade as per 3D designs attached to the contract of sale.

### **FLOOR AND WALL TILING:**

Tiles inside the property will be of modern style, top quality size 60x60.

Paved outdoor areas with top quality tiles.

Bathrooms and kitchen tiled to first 1st grade in a modern style.

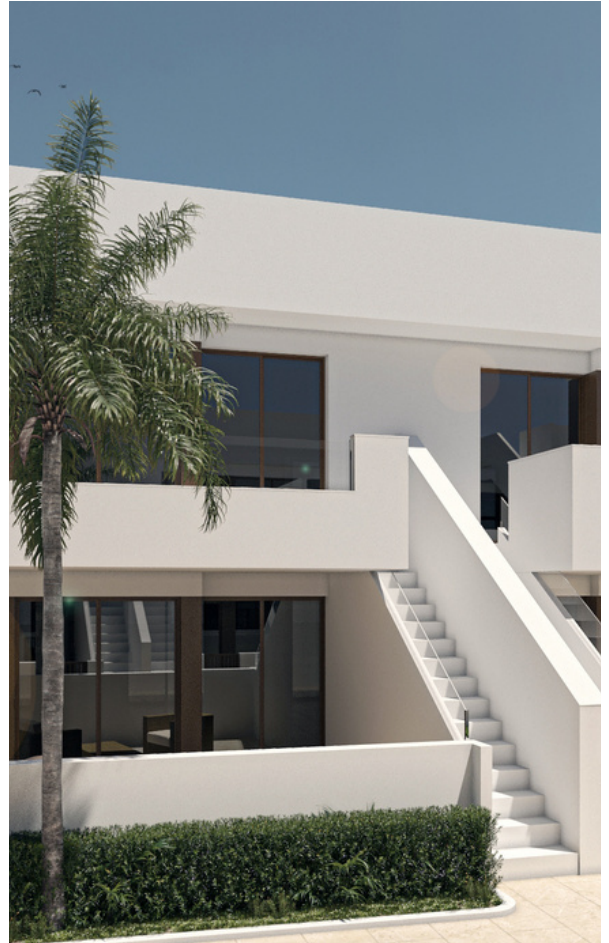

### **PAINTING:**

Smooth paint finish, in white mat finish.

### **INTERIOR CARPENTRY**

Main entrance door to the property will be a security dark brown door of aluminum paneling.

Interior joinery finished in white with chrome fittings and handles, Fitted wardrobes, with drawers, with white exterior finish.

\*Orientative images



**EXTERIOR CARPENTRY:** Aluminum

Bedroom windows and sliding doors in aluminium with shutters in the same colour in bedrooms.

Electric blind in the living room.

**GLASS:**

On all windows and sliding doors, double glass with camera.

All glasses will be solar control.

**KITCHEN:**

Kitchen units will be as per plans and 3d images.

Worktops will be from Silestone or similar material.

**PLUMBING AND SANITARY WARE:**

All plumbing with PPR pipes insulated and PVC drains.

Sanitary ware of modern design with matching taps.

Bathroom cabinets and sink will be installed suspended in both bathrooms.

Shower tray with glass partition included.

**ELECTRICITY:**

Mechanisms and switches in chrome or white finish.

Wiring for installation in all rooms of the property.

Installing communal antenna and TV in living room and all bedrooms.

Pre-installation for telecommunications and fibre connections.

Installation to meet current telecommunications regulation.

Points for indoor and outdoor lighting according to regulations.

**INSULATION:**

Thermal insulation as per current building regulations.

Sound insulation as per current building regulations.

**CLIMATIZACION:**

Pre-installation with duct vents including expulsion, white colour.

**EXTERIOR WALLS AND FENCES:**

The plots are divided by a wall of a height of 1,20 and 1,40 m in white plaster.

Galvanized entrance gate to the garden.

Galvanized door for the parking area.



- Orientative images of kitchen and bathroom

### **COMMUNAL GARDEN / OUTDOOR AREAS:**

Communal swimming 60m<sup>2</sup> , including walls, including salt purification system, stainless steel ladder.

Communal zone with trees and planting supplied by the builder.

### **APPLIANCES:**

Aero thermal system for hot water.

Are include all the whites' good of the kitchen from TEKA or similar: fridge, dishwasher, extractor, vitroceramique, oven, microwave and whasing machine.

We include halogen LED inside the house, kitchen, livingroom, bedrooms and bathrooms.

Heated floor bathroom

### **EXTRAS:**

Included in solarium artificial grass, pergola, summer kitchen and illumination.

**NOTE:** The owners or management reserve the right of materials and qualities. to make any changes on this list

The images are indicative, subject to possible modifications.

